

beginning of a curve; thence along the arc of said curve and the Northernly line of said Railroad right-of-way having a radius of 3548.10 feet which bears North 6 degrees 32' 33" West, a chord which bears South 82 degrees West 130.57 feet to a point; thence North and parallel to the East line of said 1/4 section 231.28 feet to a point; thence 89 degrees 10' 50" East 130.00 feet to the point of beginning and containing 0.669 Acres.

Yellow striping represents likely parking spaces for day time employee parking

Box Trucks

Boom Lifts

Dumpster

Dump Trailers

Pickup / Van

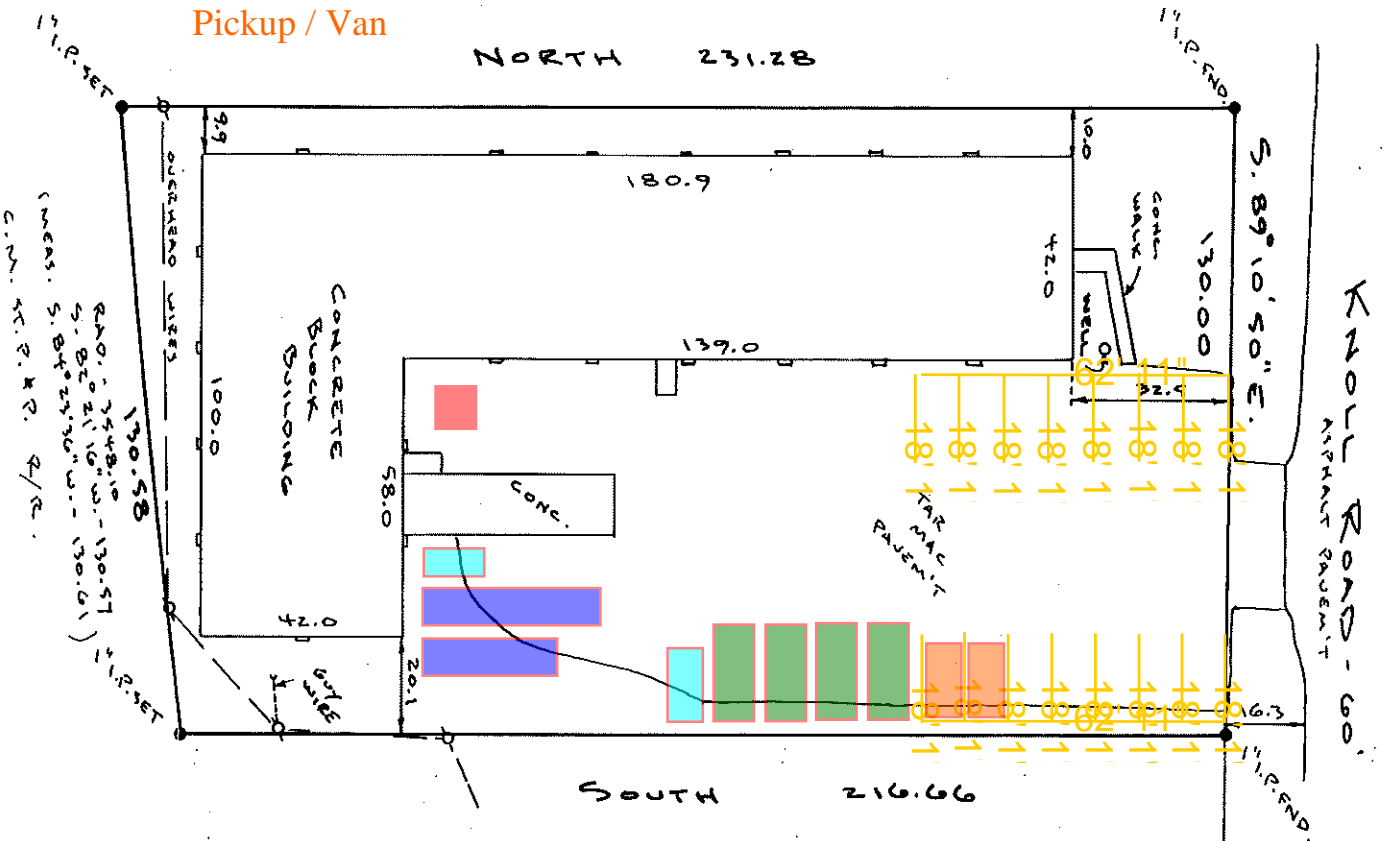

130.58  
 RAO. 74° 48' 10"  
 S. 82° 21' 10" W. - 130.57  
 S. 84° 23' 30" W. - 130.61  
 C.M. AC. B. R. 2/R.

N.E. COR. OF  
 N.E. 1/4, SEC. 25

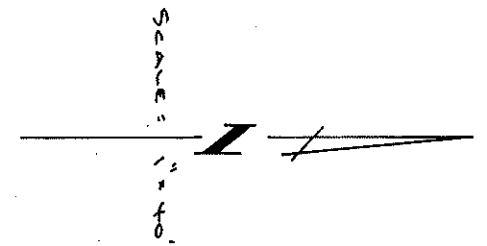

SURVEY CERTIFICATE

I HAVE SURVEYED THE ABOVE DESCRIBED PROPERTY AND THE ABOVE MAP IS A TRUE REPRESENTATION THEREOF AND SHOWS THE SIZE AND LOCATION OF THE PROPERTY, ITS EXTERIOR BOUNDARIES, THE LOCATION AND DIMENSIONS OF ALL VISIBLE STRUCTURES THEREON, FENCES, APPARENT EASEMENTS AND ROADWAYS AND VISIBLE ENCROACHMENTS, IF ANY.  
 THIS SURVEY IS MADE FOR THE EXCLUSIVE USE OF THE PRESENT OWNERS OF THE PROPERTY, AND ALSO THOSE WHO PURCHASE, MORTGAGE, OR GUARANTEE THE TITLE THERE TO WITHIN ONE (1) YEAR FROM DATE HEREOF.

Dated at  
 this 28<sup>th</sup> day of DECEMBER, 19 98



*[Handwritten signature]*