

876.46
 BENCHMARK FOR ELEVATIONS
 SEWER MANHOLE
 RIM: 876.46' VILLAGE OF
 ELM GROVE DATUM

LEGEND

- - SET IRON STAKE
- - FOUND IRON PIPE
- P/L - PROPERTY LINE
- x 100.00 - EXISTING SPOT ELEVATION
- ⊙ - SEWER MANHOLE
- ⊞ - AIR CONDITIONER
- EM - ELECTRIC METER
- GM - GAS METER
- ⊞ - UTILITY BOX
- ⊞ - UTILITY POLE
- ⊙ - CURVE TABLE ITEM
- x — - PROPOSED SILT FENCE
- □ — - METAL FENCE
- ▨ - PROPOSED CONCRETE

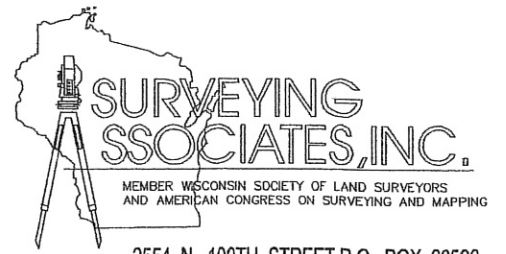

2554 N. 100TH STREET P.O. BOX 26596
 WAUWATOSA, WISCONSIN 53226
 (414) 257-2212 FAX: (414) 257-2443
 SAI@WI.RR.COM
 FREDERICK W. SHIBILSKI R.L.S.

LOT
 Tow
 Add

LOT COVERAGE

EXISTING HOUSE	2,320 SF
EXISTING SHED	99 SF
SUB TOTAL	2,856 SF (6.84 %)
PROPOSED ADDITIONS	495 SF
PROPOSED PATIOS	489 SF
PROPOSED STOOPS	88 SF
SUB TOTAL	1,072 SF (3.03 %)
HARDSCAPES (AFTER CONSTRUCTION)	
CONCRETE	166 SF
PAVERS & RT. WALL	461 SF
ASPHALT	2675 SF
SUB TOTAL	3,302 SF (9.34%)
TOTAL	7,230 SF (20.44%)

Surveyed for: **SUSAN HAISE**

"I have surveyed the above described property from the legal description furnished by the client named on this survey."
 "This survey is made for the use of the present owners of the property, and those who purchase, mortgage, or guarantee the title thereto within one year from date hereof."

WISCONSIN REGISTERED LAND SURVEYOR

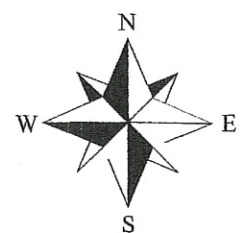

SCALE: 1" = 30'
 Area of Property = 35,372 Sq. Ft.
 0.812 Acres

CURVE	LENGTH	RADIUS	CHORD	CHORD BEARING	DELTA
C1	28.37	1070.00	28.37	S14°24'41"E	1°31'09"
C2	113.15	265.00	112.29	S02°56'21"E	24°27'49"
C3	64.24	400.16	64.17	S13°53'30"W	9°11'53"

01/18/19 - Updated Prop. Add.
 03/29/18 - Updated Prop. Add.
JULY 10, 2015
 DATE

MFS
 FIELD WORK BY

SET
 JTY
 DRAWN BY

34566
 JOB NUMBER

Jan 18, 2019 - 7:22am - Y:\SAI - Jobs Current\34566 - Haise - BND - 1015 San Jose Dr., Elm Grove.dwg\34566-2019.dwg